

Bautech CREATIVO ONE for wall

Decorative plaster with concrete structure, with increased hydrophobic parameters, approx. 1.5 mm-thick

DESCRIPTION

Bautech CREATIVO ONE™ is a thin-layer system for creating decorative plasters with an architectural concrete structure. It contains polymers, hard aggregates, as well as appropriate admixtures and pigments.

USES

- For creating decorative plasters on walls, coatings on doors, and furniture fronts.
- For coating mineral plaster, gypsum plaster, drywalls, as well as wooden, metal, and glass surfaces.
- For use on vertical surfaces in wet areas,* such as bathrooms, kitchens, spa, etc.
- For indoor applications: in apartments, offices, shops, restaurants, etc.

* When applying in wet areas with high humidity levels, it is required to consult with Bautech Technical Department.

BENEFITS

- Thin-layer solution (approx. 1.5mm)
- Can be applied on various substrates
- High adhesion to substrate
- Highly resistant to wearing and scratching
- UV-resistant, no yellowing
- Easy to keep clean
- Wide range of colours
- For indoor use

APPLICATION CONDITION

- Substrate moisture - max. 4%
- Air humidity - max. 75%
- Substrate temperature - min. + 15 ° C.
- The substrate temperature should be at least 3°C above the dew point temperature.
- The ambient temperature during work and for the next 5 days should be between + 15 ° C and + 25 ° C.
- The surface should be protected against too rapid moisture loss, loss of moisture due to e.g. high temperatures, drafts, solar radiation, etc.
- All work should be carried out using appropriate tools. Walls should be protected against dust, dirt and contamination.
- An adequate lighting should be provided.

SUBSTRATE PREPARATION

Substrate should be stable and durable, uniform, cleaned of dust, lime, grease, dirt, oil, wax, and residues of chalk, lime,

emulsion and oil paints. Remove old coatings with insufficient adhesion and fill cavities.

Check the absorbency of the substrate by applying a test layer on a small area. After drying, the bonding coat Bautech CONTACTO should be permanently bound to the substrate. If it delaminates, before applying Bautech CONTACTO™, the substrate should be primed with any available primers to reduce its absorptivity.

SECTION

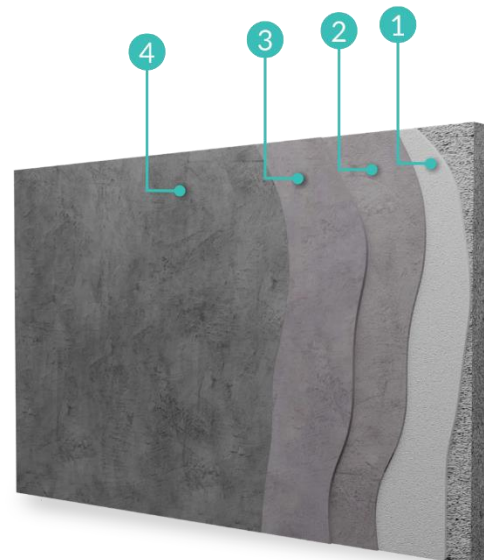

1. BAUTECH CONTACTO
2. BAUTECH CREATIVO ONE
3. BAUTECH CREATIVO ONE
4. BAUTECH BAUPUR PRIMER 600HP



	ORDER OF OPERATION/LAYER	PRODUKT	COVERAGE
1.	Bonding layer application	Bautech CONTACTO™	approx. 0.2kg/m ²
2.	surface sanding and cleaning		80 grit sandpaper
3.	Application of the 1st coat of plaster	Bautech CREATIVO ONE™	0.5- 0.7kg/m ²
4.	surface sanding and cleaning		60-100 grit sandpaper or polishing pad min 100
5.	Application of the 2nd coat of plaster	Bautech CREATIVO ONE™	0.2- 0.3 kg/m ²
6.	surface sanding and cleaning		80-100 grit sandpaper or polishing pad min 100
7.	Plaster sealing	Bautech Baupur 600 HP PRIMER™	approx. 0.06 kg/m ²
8.	Surface varnishing (2 coats) in wet areas	Bautech Baupur 700 HP™	0.07- 0.10l/m ²

APPLICATION

- Apply each coat of the CREATIVO ONE™ after the previous one is completely dry.
- Sand CREATIVO ONE™ from 2 to 12 hours after application. Avoid to excessive sanding of the surface.
- Seal the surface with protective sealer BAUPUR 600 HP min 24 hours after application of CREATIVO ONE.
- Protected against a rapid loss of moisture, caused by high temperatures, draught, air conditioning, etc.
- To eliminate differences in colour shades during application of Bautech CREATIVO ONE™, use material with the same date of manufacture and batch number printed on the packaging.

NOTE: Each products included in the Bautech CREATIVO ONE system for wall should be apply in accordance with guidelines provided in product data sheets.

SPEED OF CURE

At the temperature of +20°C and relative humidity of 60-70%: after 7 days from applying the varnish.

STORAGE AND TRANSPORTATION

According to the technical data sheets of the products included in the system.

TOOL CLEANING

The tools should be cleaned with water immediately after use. Mechanically remove bonded material.

HEALTH AND SAFETY

For Safety Data Sheets please contact our Export Department.

AVAILABLE COLOURS

According to the colour range

PACKAGING

The products included in the Bautech CREATIVO ONE™

- Bautech CONTACTO™ : 4 kg, 10 kg,
- Bautech CREATIVO ONE™ plaster: 10 kg
- Bautech BAUPUR 600 HP PRIMER: 1 l, 5 l

ADDITIONAL INFORMATION

Although the manufacturer guarantees the quality of the product, they have no influence on the method of its application and use.

All information contained herein refer to products stored and used in compliance with the recommendations, it is provided in good faith, and takes into account the current state of knowledge and the experience gained by Bautech®. The User is obliged to use the product in compliance with its intended purpose and Bautech's recommendations. All the technical data provided are based on laboratory tests and trials. The practical measurement results may not be identical, resulting from conditions, location, method of application, and other circumstances beyond Bautech's control. If our employees provide different recommendations, they must be made in writing to be valid. All previous manuals will become invalid on the date of publishing this latest manual.

The surfaces may show differences in shade and appearance, depending on the conditions and method of work execution, drying conditions, etc. It should not be considered as a product defect and has no impact on the technical parameters and functional properties of the decorative plaster. Colour variations of the plaster can also be the result of a heterogeneous substrate. Use Bautech's colour templates as a guide. The final result may differ from the presented Bautech samples, depending on the method of manufacturing, sanding, and impregnation applied. If in doubt, perform your own tests or contact the Bautech's Technical Department.